

3RD ANGLE PROJECTION  
DO NOT SCALE

DENOTES LATEST ISSUE CHANGES

DENOTES CRITICAL VALUE

TOLERANCES UNLESS OTHERWISE STATED

0 DEC. PLACE	±0.5	2 DEC. PLACES	±0.1
1 DEC. PLACE	±0.2	ANGULAR	±1°

© 2020 A3 THIS DOCUMENT MUST NOT BE COPIED OR DISCLOSED TO A THIRD PARTY WITHOUT THE WRITTEN CONSENT OF PANORAMA ANTENNAS LTD.

DWG. No. **SP5-0470-VAR**

PART No.	HOLE DIAMETER (A)	HOLE DIAMETER (B)	WEIGHT
SP5-0470	15.0 mm	7.0 mm	67.3g
SP5-0470-A	16.0 mm	7.0 mm	67.1g
SP5-0470-C	15.0 mm	12.5 mm	65.3g

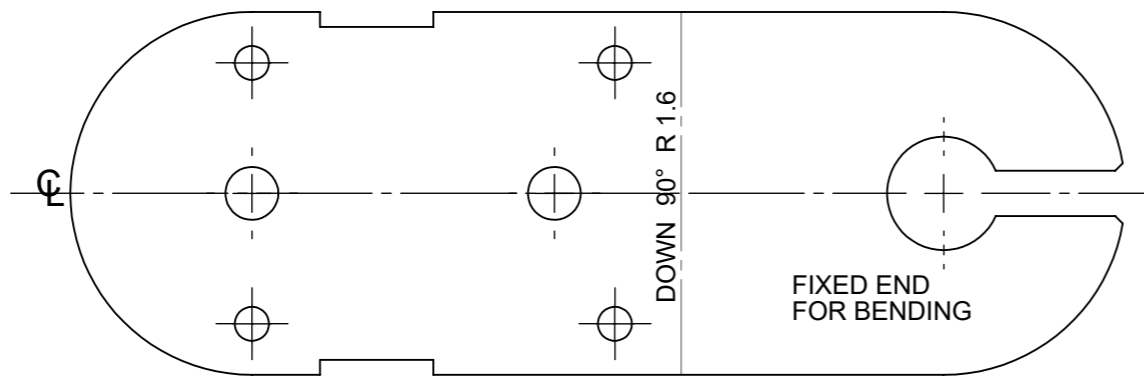

FLAT PATTERN SCALE 1:1

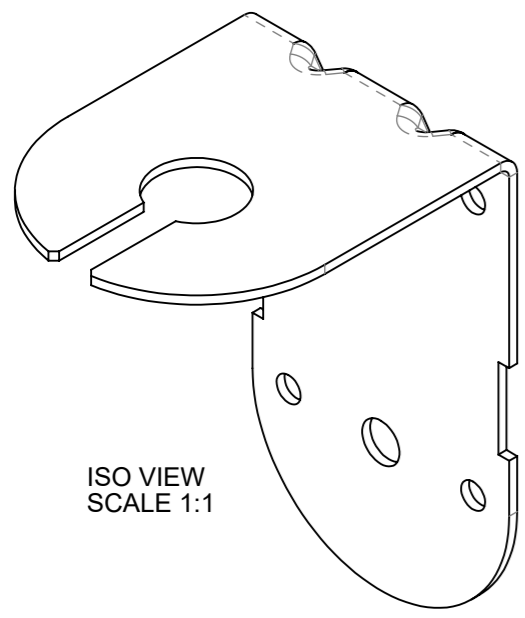

ISO VIEW SCALE 1:1

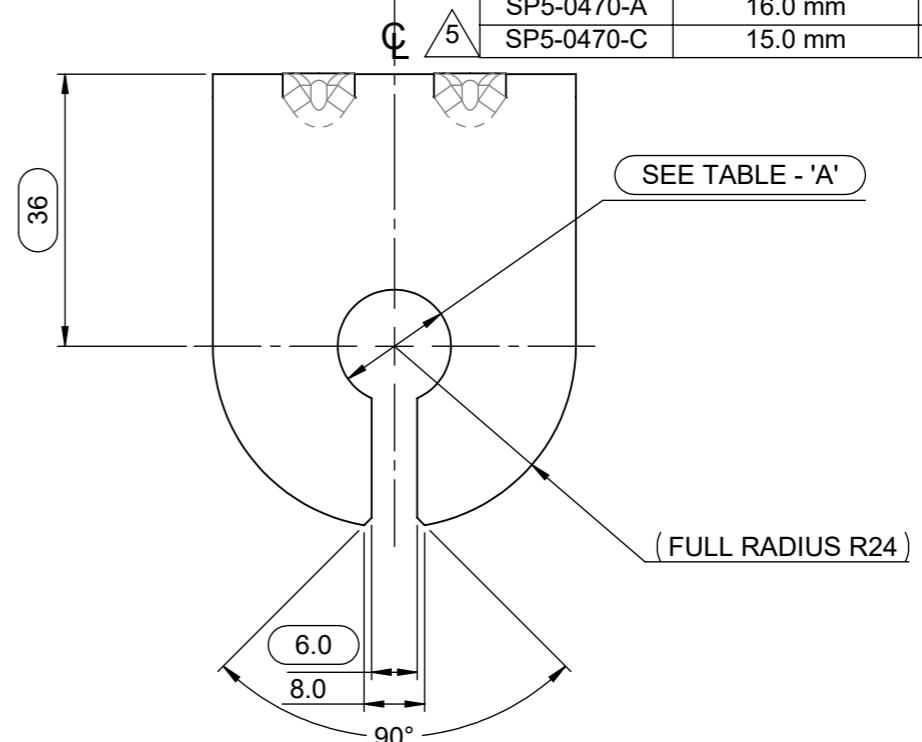

SEE TABLE - 'A'

(FULL RADIUS R24)

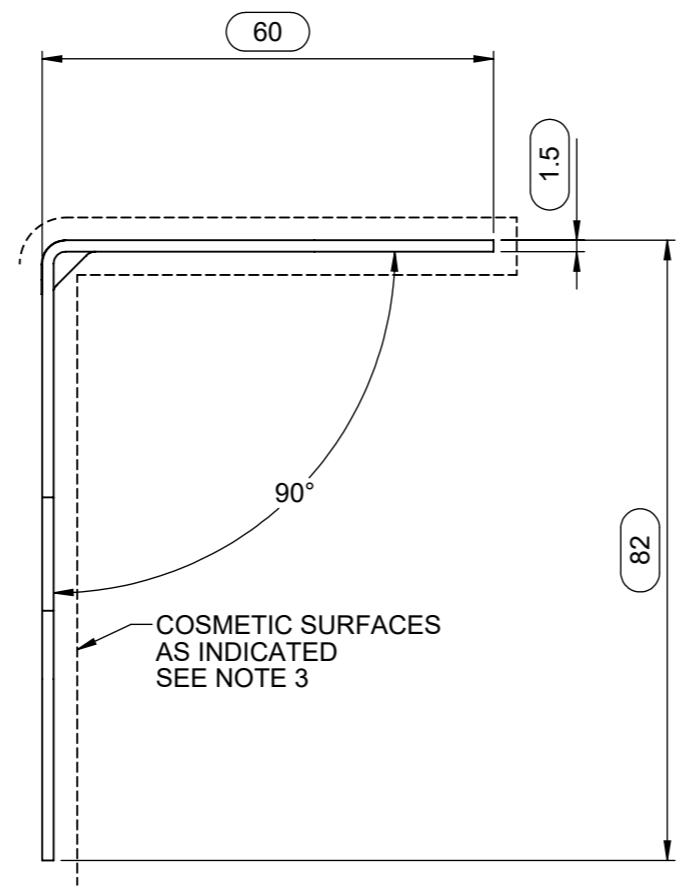

COSMETIC SURFACES AS INDICATED SEE NOTE 3

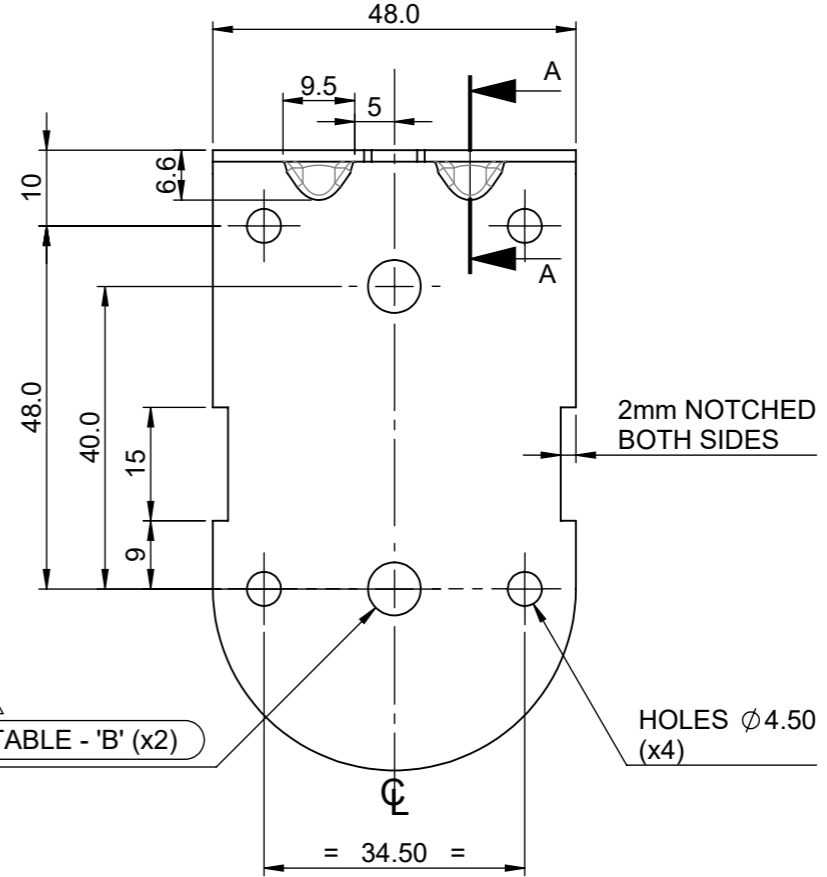

SEE TABLE - 'B' (x2)

HOLES Ø 4.50 (x4)

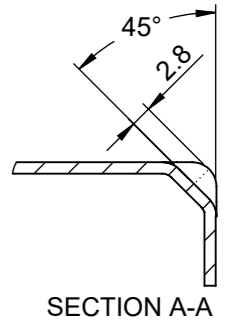

SECTION A-A

NOTES:



- COMPONENT TO BE FLAT AND BENT AT 90° AS SHOWN. BEND RADIUS TO ALLOW FOR FINISHED DIMENSIONS SHOWN.
- REMOVE ALL BURRS AND SHARP EDGES.
- ALL DIMENSIONS APPLY AFTER PLATING/FINISHING. COSMETIC SURFACES TO BE FREE FROM OIL, DIRT AND DAMAGE.
- FINISH: CLEAR PASSIVATED (Cr III ELV/ROHS COMPLIANT TRIVALENT CHROMIUM) OR SIMILAR, FOLLOWED BY ZINC PLATING (9µm MIN), ALTERNATIVES TO BE APPROVED BY PANORAMA ANTENNAS.
- REFER TO 3D FILE FOR OTHER DIMENSIONS.
- SAMPLES MUST BE APPROVED BY PANORAMA ANTENNAS Q.C. BEFORE COMMENCING PRODUCTION.
- ALL MATERIALS SUPPLIED MUST BE RoHS3 (DIRECTIVE (EU) 2015/863) COMPLIANT AND MUST NOT CONTAIN ANY SUBSTANCES OF VERY HIGH CONCERN (SVHCs) LISTED UNDER REACH OR POLY-AROMATIC HYDROCARBONS (PAHs), OR PERSISTENT ORGANIC POLLUTANTS (POPs) CONTROLLED BY THE STOCKHOLM CONVENTION.

PCN	REV.	DESCRIPTION	DATE	DRN.
01019	3	PART CHANGED TO -VAR. TABLE ADDED. NOTES AND PLATING THICKNESS UPDATED.	23/09/2014	PE
01019	4	DIM. UPDATED FOR CLARITY, NOTES UPDATED.	26/01/2017	AR
01019	5	SP5-0470-C ADDED. NOTES UPDATED.	28/10/2020	IC

PRODUCT/ASSEMBLY 2007 - CASTINGS, PRESSINGS AND MILLED COMPONENTS
MATERIAL MILD STEEL
FINISH SEE NOTES

DESCRIPTION ANGLE BRACKET - VARIOUS	
APPROVED PE	D.O. CHECK CL
SCALE 1:1	DIMENSIONS IN mm

